

UBIK

R&D POLIFORM (2003)



DESCRIPTION

Ubik offers an innovative organization for tidiness, with a wide range of containers and accessories dedicated to specific functions: trays, drawers with the front in wooden finish or glass, extractable shoe rack, trousers hanger, shirts tray. For a walk-in wardrobe which boasts both functionality and style.

Poliform

UBIK

R&D POLIFORM (2003)



Poliform

UBIK

R&D POLIFORM (2003)

DIMENSION

ubik walk-in closet

UBIK WALL PANELING

How to calculate the dimensions

To obtain the total width, add up the back panel widths mm 32 - 1 1/4" for the initial lateral profile, mm 4 - 1/4" for each rack and 1 1/4" for the end lateral side.

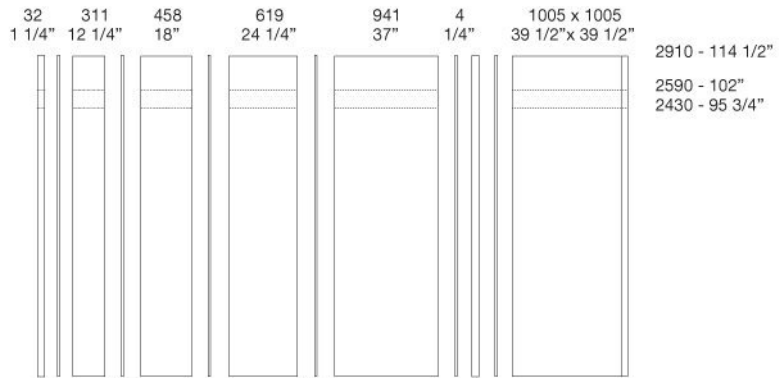

Depth Ubiq wall paneling

mm 460 - 18" and mm 605 - 23 3/4"



UBIK PROFILE WITH RACK

How to calculate the dimensions

To obtain the total width, add up the shelves widths, mm 24 - 1" for the initial lateral profile, mm 4 - 1/4" for each rack and mm 24 - 1" for the ending lateral profile.

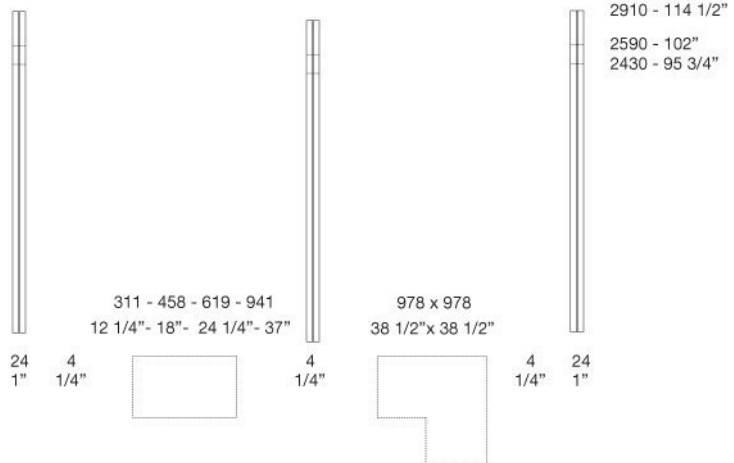

Depth Ubiq profile with rack

mm 434 - 17" and mm 579 - 22 3/4"

UBIK

R&D POLIFORM (2003)

DIMENSION

walk-in closet

DEPTH MM 400 - 15 3/4" - THICKNESS MM 35 - 1 1/2"

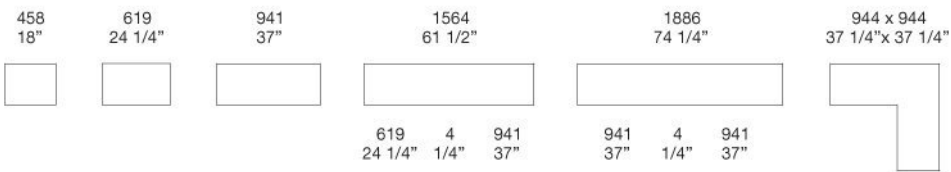

NB

Shelves w 61 1/2" and 74 1/4" are available for wall paneling only.

DEPTH MM 545 - 21 1/2" - THICKNESS MM 35 - 1 1/2"

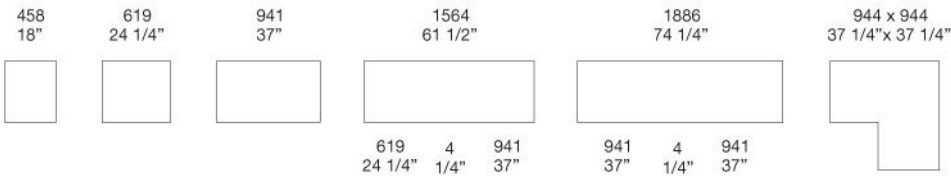

UBIK

FINISHINGS\BACKS\GLOSSY GLASS (6)



2201 WHITE
EXTRALIGHT

2273
GHIACCIO

1204
GRAFITE

1235 CANAPA

1264 ARENA

1203 NERO

UBIK

FINISHINGS\BACKS\WHITE MIRROR (1)



4000 BIANCO

UBIK

FINISHINGS\BACKS\MELAMINE (4)

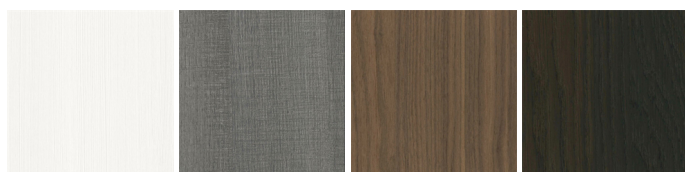

MELAMINE
ARTIK WHITE

MELAMINE
CENERE OAK

NOBILITATO
NOCE-C

MELAMINE
SPESSART
OAK

UBIK

FINISHINGS\BACKS\SKIN MELAMINE (5)

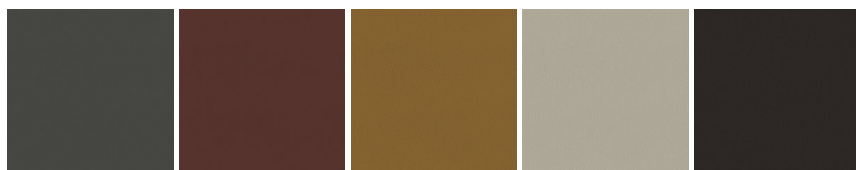

ELEFANTE

MATTONE

SENAPE

LATTE

MORO

UBIK

FINISHINGS\EQUIPMENTS\MELAMINE (4)

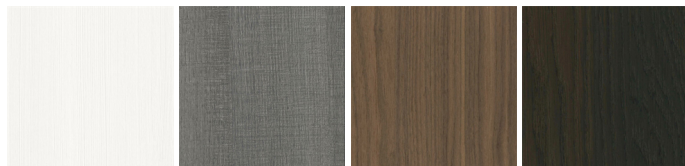

MELAMINE
ARTIK WHITE

MELAMINE
CENERE OAK

NOBILITATO
NOCE-C

MELAMINE
SPESSART
OAK

UBIK

FINISHINGS\EQUIPMENTS\TECNO-LEATHER (5)



01 ELEFANTE

02 MORO

03 SENAPE

04 MATTONE

05 LATTE

UBIK

FINISHINGS\SHELVES - CHESTS OF DRAWERS TOPS- DRAWERS BOTTOM\TECNO-LEATHER (5)



01 ELEFANTE

02 MORO

03 SENAPE

04 MATTONE

05 LATTE